



SERIES 38M

ECONOMICAL 3 WAY MULTI-PORT THREADED END BALL VALVE

PRODUCT FEATURES

- Investment Casting Body & Caps
- All Stainless Steel Construction
- Variety of Thread Standards Available
- L or T Port Options
- Built-In ISO 5211 Mounting Dimension
- Blow-Out Proof Stem
- 4 seats for rigid ball supporting
- Locking in every 90° increment

SPECIFICATION

- Reduced Port
- Size Available from 1/4" to 3"
- Pressure Rating: PN63/1000cwp

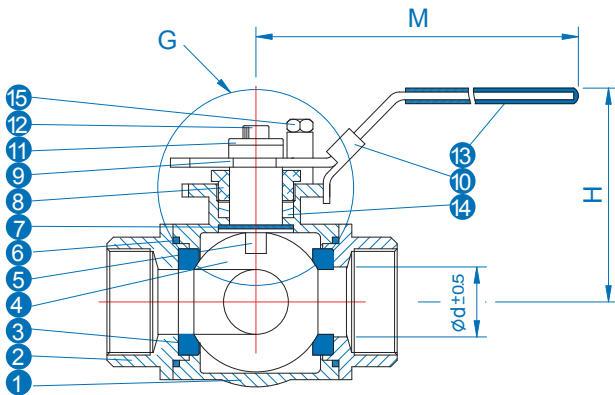

MATERIAL OF CONSTRUCTION

NO.	PART NAME	MATERIAL	Q'TY
1	BODY	CF8M / 1.4408	1
2	END CAP	CF8M / 1.4408	3
3	BALL SEAT	RPTFE	4
4	BALL	ASTM A351 Gr. CF8M	1
5	STEM	316SS	1
6	JOINT GASKET	PTFE	2
7	THRUST WASHER	PTFE	1
8	GLAND	304SS	1
9	HANDLE	304SS	1
10	LOCATING LOCK	304SS	1
11	WASHER	304SS	1~3
12	HANDLE NUT	304SS	1
13	HANDLE SLEEVE	VINYL	1
14	STEM PACKING	PTFE	1 Set
15	STOP PIN	304SS	1

Pressure Vs. Temperature Chart

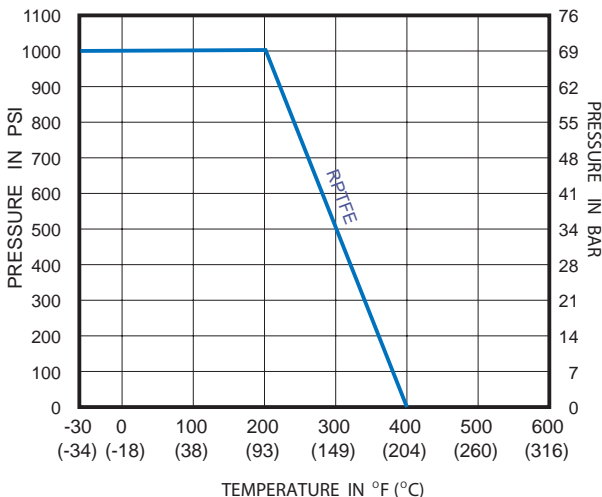

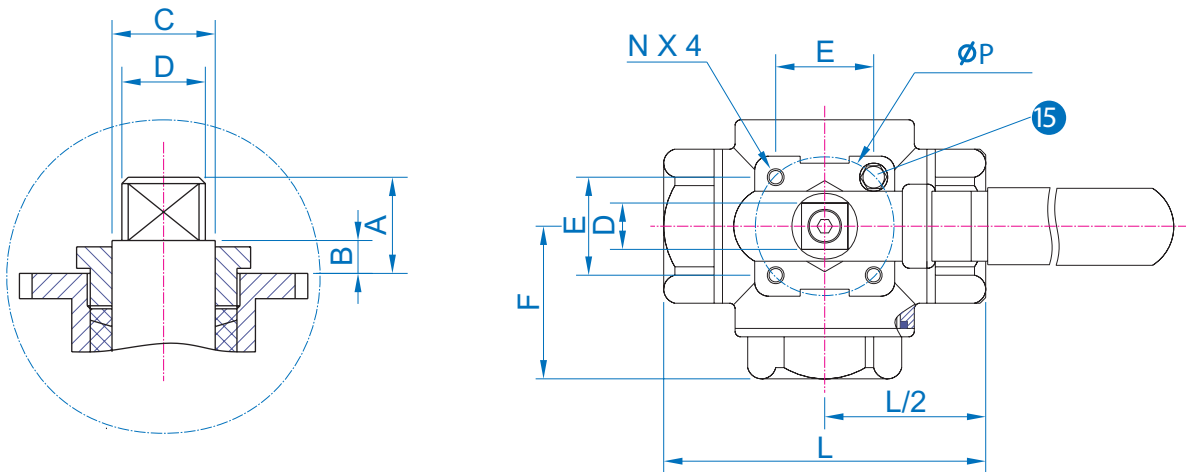

DIMENSIONS (mm)

SIZE	∅d±0.2	L±0.8	H±1.0	M±1.0	A	B	C	D	E	F	∅P	N
1/4"	11.0	69	58.0	133	10.0	6.0	12.0	9	29.7	35.10	42	M5*0.8
3/8"	11.0	69	58.0	133	10.0	6.0	12.0	9	29.7	35.10	42	M5*0.8
1/2"	12.7	75	64.1	133	11.0	6.0	12.0	9	29.7	38.00	42	M5*0.8
3/4"	16.0	86	82.4	180	13.9	7.0	15.0	11	35.4	44.70	50	M6*1
1"	20.0	102.4	86.1	180	20.0	8.5	15.0	11	35.4	51.40	50	M6*1
1-1/4"	25.0	118	91.4	210	23.0	7.8	15.0	11	35.4	57.50	50	M6*1
1-1/2"	32.0	125	102.7	210	26.0	10.0	15.0	11	49.5	62.70	70	M8*1.25
2"	38.1	149	110.7	228	26.1	10.0	18.5	14	49.5	74.60	70	M8*1.25
2-1/2"	50.0	160	115.8	228	24.5	8.5	18.5	14	49.5	80.00	70	M8*1.25
3"	65.0	185	132.0	265	25.5	9.0	21.0	17	72.1	92.50	102	M10*1.50

FLOW PATTERNS FOR 3 WAY VALVES

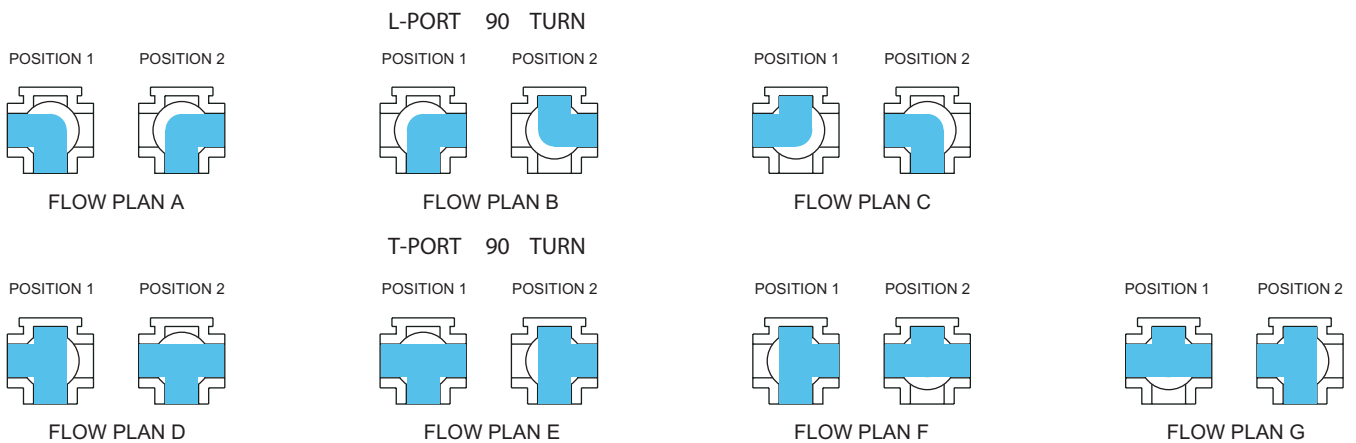

ORDERING INFORMATION

38M	-	N	3	1	R	G	-	D	2
		NPT	FULL PORT	SS316	RPTFE	1-1/2"		1000 cwp	STANDARD HANDLE
38M MULTI-PORT		END CAP TYPE	PORT TYPE	BODY/END CAP MATERIAL	SEAT MATERIAL	SIZE		PRESSURE	HANDLE TYPE
	N	THREADED END(NPT)	3 REDUCED PORT	1 316 CF8M 1.4408 SCS14	R RPTFE	A 1/4"	D	PN63/1000cwp	1 STANDARD HANDLE W/LOCK
	P	THREADED END(PF)				B 3/8"			2 STANDARD HANDLE
	H	THREADED END(PT)				C 1/2"			
						D 3/4"			
						E 1"			
						F 1-1/4"			
						G 1-1/2"			
						H 2"			
						K 3"			